

PERIPHERALS



PERIPHERALS

TOOLING MATE

- For mounting and removal of PULLSTUD BOLTS and tools!

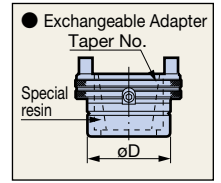
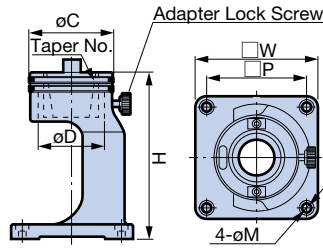

Model	Taper No.	øC	øD	H	□ W	□ P	øM	Adapter Model
TMS40-30	30	76	60	150	110	90	7 (for M6)	TMA40-30
-40	40							-40
TMS50-40	40	105	88	190	160	130	9 (for M8)	TMA50-40
-50	50							-50

1. One adapter is included with the body.
2. Adapters are also available separately.
3. Adapter Lock Screw is also available separately. (Model **RTM0615**)
4. Cap bolts (4 pcs) for mounting on a workbench or surface plate are not included.

Caution: Use after securely bolting to a workbench or surface plate.

[For HSK/BIG CAPTO SHANK]

- Unique needle roller clamping method.
The tool is safely fastened without damaging the taper.

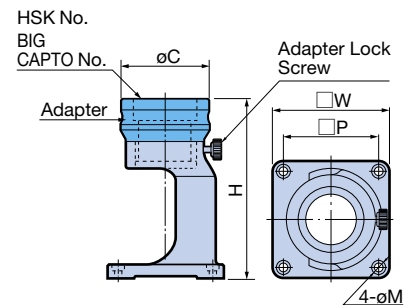

Model	HSK No.	BIG CAPTO No.	øC	H	□ W	□ P	øM	Adapter Model
TMS40-32R	32	—	76	165	110	90	7 (for M6)	TMA40-32R
-40R	40	C4	76	165				-40R
-50R	50	C5	76	165				-50R
-63R	63	C6	87	172				-63R
TMS50-80R	80	C8	114	215	160	130	9 (for M8)	TMA50-80R
-100R	100	—	124	219				-100R

1. One adapter is included with the body.
2. Adapters are also available separately.
3. Adapter Lock Screw is also available separately. (Model: **RTM0615**)
4. The body (blue component) is compatible with other Tooling Mates as far as the first 2 digits of the model number are identical.
5. Cap bolts (4 pcs) for mounting on a workbench or surface plate are not included.

Caution: Use after securely bolting to a workbench or surface plate.

Tap Collet fastening jig TC MATE

- Easy tap mounting and removal for Tap Collets TC8, TC12, TC20, and TC30!

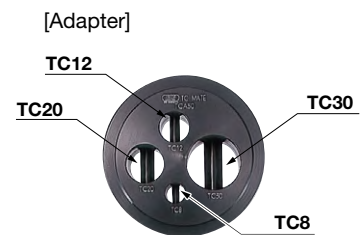
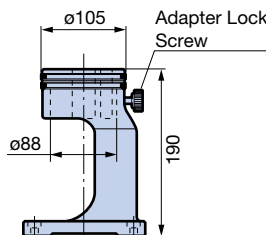

Model **TCM50**

1. One adapter is included with the body.
2. Adapter is also available separately.
3. Adapter Lock Screw is also available separately. (Model: **RTM0615**)
4. The body (blue component) is compatible with other Tooling Mates as long as the first 2 digits of the model number are identical.
5. Cap bolts (4 pcs) for mounting on a workbench or surface plate are not included.

Caution: Use after securely bolting to a workbench or surface plate.

Model **TCA50**

Exchangeable with existing adapter of your TMS50 Tooling Mate.

TOOLING MATE UNIVERSAL

- With flexible positions of vertical, horizontal and diagonal, tool setup time is drastically reduced.

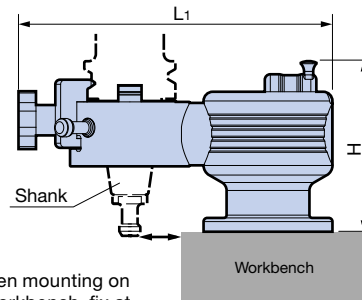

When mounting on a workbench, fix at a location without interference with the pullstud bolt.

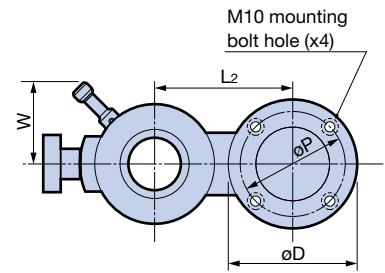

Model	Shank	L ₁	L ₂	øD	H	W	Mounting bolt hole		Weight (kg)
							øP	Size	
TMU50-50	BT50, BBT50	340	150	140	185	89	114	M10	20

Cap bolts (4 pcs) for mounting on a workbench or surface plate are not included. The max. acceptable length of the bolt is 50mm.

Caution: Use after securely bolting to a workbench or surface plate.

±90° tilt Solidly fixable at every 45°

The holder can be securely fixed at inclinations of every 45°. Work high in loads such as tightening pullstud bolts can be securely performed.

0°

±45°

±90°



360° rotation Ideal for replacing inserts

Mounting is easy and fast, as inserts can be replaced while rotating the holder 360°. (indexable at every 45°)



PERIPHERALS

HOLDER LOCK

- Tool clamp stand exclusive for horizontal mode.

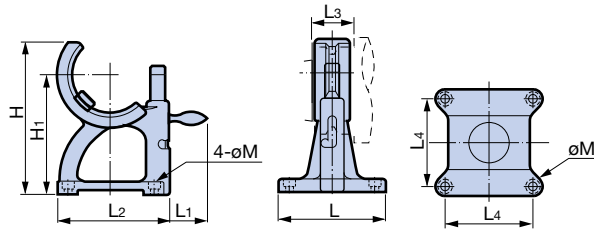

Prevents tools from falling into the chuck when mounting small-diameter tools.

Model	Taper No.	L	L ₁	L ₂	L ₃	L ₄	H	H ₁	øM	Fixing cap
HL-BT30	BBT/BT30	82	31	82	26	65	120	100	7 (for M6)	HL-30CP
HL-BT40	BBT/BT40	98	33	98	32	80	140	115		HL-40CP
HL-BT50	BBT/BT50	124	43	131	44	100	178	140	9 (for M8)	HL-50CP

1. Fixing caps are also available separately.
2. HOLDER LOCKs are exclusive for BBT/BT shank holders.
3. Cap bolts (4 pcs) for mounting on a workbench or surface plate are not included.

Caution: Use after securely bolting to a workbench or surface plate.

For HSK/BIG CAPTO SHANK KOMBI GRIP

- A unique clamping method using 2-way clutch needle rollers on the flange periphery.
- The tool can be safely fastened without damaging the taper.

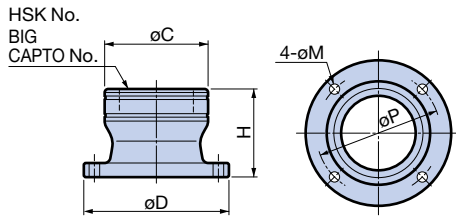

Model	HSK No.	BIG CAPTO No.	øC	øD	H	øP	øM
KG 25R	25	—	48	79	65	62	7 (for M6)
32R	32	—	55	85		69	
40R	40	C4	63	93	77		
50R	50	C5	75	105	70	89	9 (for M8)
63R	63	C6	88	123.5	75	105.5	
80R	80	C8	107	142	90	124	
100R	100	—	127	162	100	144	

1. Cap bolts (4 pcs) for mounting on a workbench or surface plate are not included.

Caution: Use after securely bolting to a workbench or surface plate.

For ST SHANK ST LOCK

- Fixes cylindrical shank tools, ideal for tightening nuts.
- Supports cylindrical shank diameters of ø20, ø25, and ø32.

Cylindrical Shank exclusive

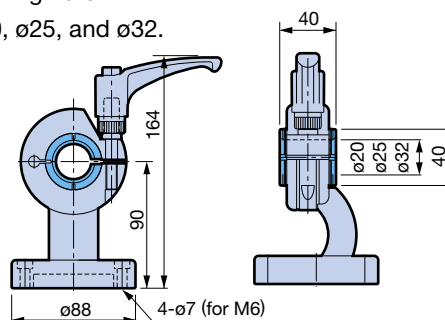

Advice

Also available for holders with small size interfaces including HSK-E25 and 32.

1. One sleeve each of ø20, ø25, and ø32 is included.
2. Do not clamp without a tool.
3. Cap bolts (4 pcs) for mounting on a workbench or surface plate are not included.

Caution: Use after securely bolting to a workbench or surface plate.

Model **STL40**

<For holder bores> Cleaning tool

WIPER CLEANER (for chuck bore: $\varnothing 6 - \varnothing 12$)

- Developed for cleaning the clamping bores such as hydraulic chucks and shrink fit holders.

Use a cleaner matching the chuck bore size.

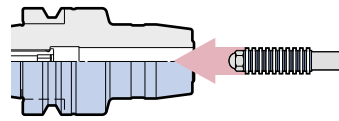

Ideal for small-diameter bores!
Insert and extract the cleaner to remove inner chips, particles and oil.



Inner diameter $\varnothing 6$ and up

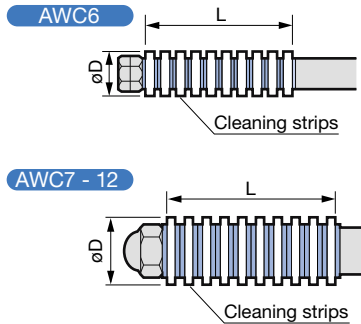

Model	$\varnothing D$	L
AWC 6	6	20
AWC 7	7	
AWC 8	8	
AWC 9	9	26
AWC10	10	
AWC11	11	31
AWC12	12	

1. $\varnothing D$ in table = supported holder bore $\varnothing d$

TK CLEANER PAT. (For chuck bores: $\varnothing 13 - \varnothing 42$)

- Wipes off particles and oil in chuck bore and keeps your machining safe and secure.

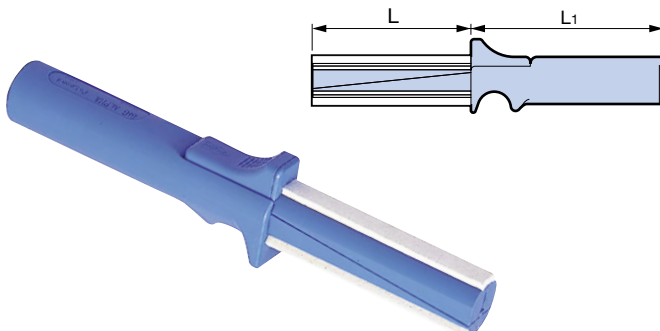

For MEGA DOUBLE POWER CHUCK/
NEW Hi- POWER MILLING CHUCK/HYDRAULIC CHUCK

Model	Supported holder bore $\varnothing d$	L	L ₁	Number of cleaning strips
TKC13	13	60	106	2
14	14			
15	15			
16	16			
18	18	70		
20	20			
25	25	80	121	3
32	32	100		
40	40	105		4
42	42			

※ Select in accordance with the chuck bore

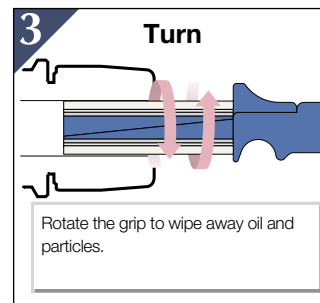
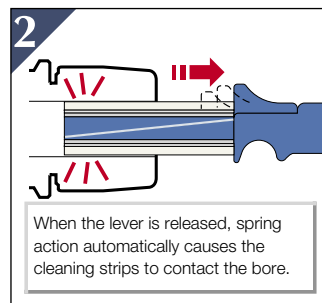
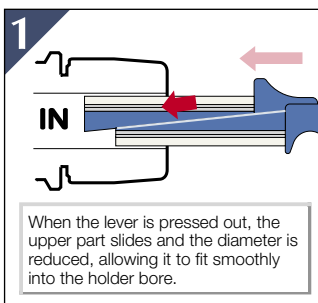

Automatic cleaning tools, convenient for factory automation.

FLANGE FACE CLEANER



For spindle flange face

Automatically cleans the spindle flange face of BIG-PLUS machines.
Enables stabler DUAL CONTACT machining.

For details, **A171**

PERIPHERALS

<For holder bores> Cleaning tool
α Taper Cleaner

- Removes oil and particles from the chuck bore taper.

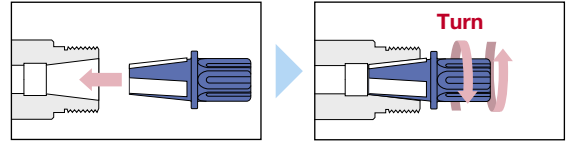

For MEGA MICRO CHUCK

Model	Body Model
SC-NBC3S	MEGA3S
SC-NBC4S	MEGA4S
SC-NBC6S	MEGA6S
SC-NBC8S	MEGA8S

For MEGA NEW BABY CHUCK/
NEW BABY CHUCK

Model	Body Model
SC-NBC 6	MEGA 6N / NBS 6
SC-NBC 8	MEGA 8N / NBS 8
SC-NBC10	MEGA10N / NBS10
SC-NBC13	MEGA13N / NBS13
SC-NBC16	MEGA16N / NBS16
SC-NBC20	MEGA20N / NBS20

For MEGA E CHUCK

Model	Body Model
SC-MEC 6	MEGA 6E
SC-MEC 8	MEGA 8E
SC-MEC10	MEGA10E
SC-MEC13	MEGA13E

For ER CHUCK



Model	Body Model
SC-MER11	MEGA ER11
SC-MER16	MEGA ER16
SC-MER20	MEGA ER20
SC-MER25	MEGA ER25
SC-MER32	MEGA ER32

<For holder tapers> Cleaning tool
α TOOLING CLEANER

- The taper and flange face are cleaned simultaneously.

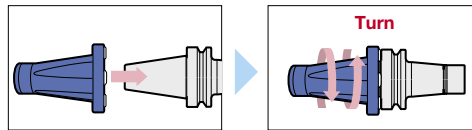

Model	Shank
SCE-30	BBT30 / BT30
SCE-40	BBT40 / BT40

SPINDLE CLEANER

- Completely removes oil and particles from machine spindle and holder bore!

■ For ISO Taper Spindle

■ For Morse Taper Spindle



Model	Taper
SC20	BBT/BT20 (NT20)
SC30	BBT/BT30 (NT30)
SC40	BBT/BT40 (NT40)
SC45	BBT/BT45 (NT45)
SC50	BBT/BT50 (NT50)



Model	Taper
SC1	MT1
SC2	MT2
SC3	MT3
SC4	MT4
SC5	MT5
SC6	MT6

1. Also available for the bore of Morse taper holders.

■ For HSK Spindle



Model	Spindle
SC-HSK 32	HSK-A 32
40	HSK-A 40
50	HSK-A 50
63	HSK-A 63
80	HSK-A 80
100	HSK-A100

Model	Spindle
SC-HSK25E	HSK-E 25
32E	HSK-E 32
40E	HSK-E 40
50E	HSK-E 50

T-SLOT CLEAN

Set in the T-slot on machine tables to prevent chips from being packed.

- Flattens surface of the table and aids quick removal of chips.
- Three sizes of groove widths are available to match the machine table. (T-slot widths 14/18/22mm)

Setup time greatly reduced



Before use

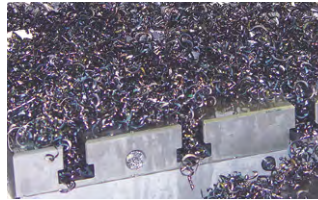

After use



Removal pin included

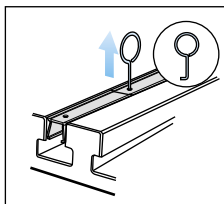

Other manufacturers

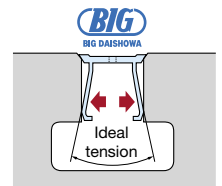
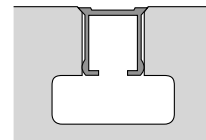

Due to the uniquely angled shape of the table T-slot contact part, slipout is prevented and chips are completely shut out.

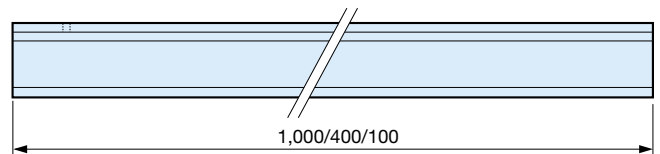
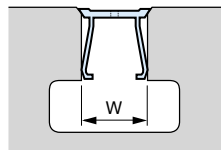

※ Cut for use, for dimensions not listed above.

Standard set

Set Model	W	Set contents
TS14-S	14	400mm x 4 pcs
TS18-S	18	100mm x 4 pcs
TS22-S	22	Removal pin x 1 pc

400mm set

Set Model	W	Set contents
TS14-400L-100P	14	400mm x 100 pcs
TS18-400L-100P	18	Removal pin x 10 pcs
TS22-400L-100P	22	

Ideal for T-slots in large machines!

1,000mm set

Set Model	W	Set contents
TS18-1000L-10P	18	1,000mm x 10 pcs
TS22-1000L-10P	22	Removal pin x 1 pc

TOOLING WAGON

- Tools with various types and sizes of shank can be stored.

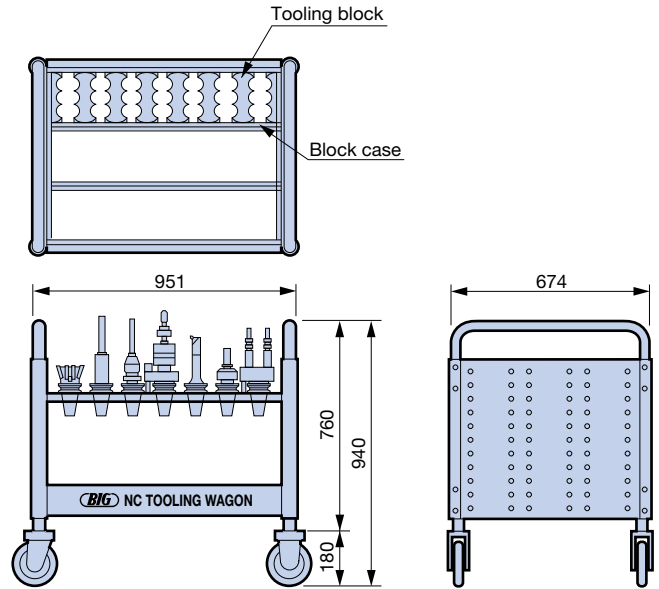

Standard type (With 3 block case sets <30 tooling blocks>)

Model	Number of tools storable with one wagon	Weight (kg)
TW-1	BT50, BT45 } 7 tools in 1 row NT50, NT45 } 21 tools in 3 rows	43.8
	BT40, BT35, BT30 } 18 tools in 1 row NT40, NT35, NT30 } 54 tools in 3 rows	

Block case (Optional) <With 10 tooling blocks>

Model	Number of tools storable in 1 block case row (10 pcs)
TW-B	For BT50 Shank.....7 tools
	For BT40 Shank.....18 tools
	For BT30 Shank.....18 tools